

NOTE: WRITTEN DIMENSIONS ON THESE DRAWINGS SHALL HAVE PRECEDENCE OVER SCALED DIMENSIONS. CONTRACTORS SHALL VERIFY AND BE RESPONSIBLE FOR ALL DIMENSIONS AND CONDITIONS SHOWN IN THESE DRAWINGS. ANY DISCREPANCY ON ALL DIMENSIONS & SPECIFICATIONS SHALL BE THE RESPONSIBILITY OF THE CONTRACTOR. MECHANICAL ETC. SHALL BE SUBJECT FOR VERIFICATION.

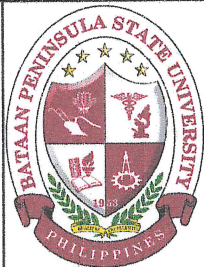

BATAAN PENINSULA STATE UNIVERSITY
TECHNICAL WORKING GROUP FOR INFRASTRUCTURE
CAPTOL COMPOUND, BRGY. TENDILERO, CITY OF BALANGA, BATAAN
E-MAIL: bpsu@bpsu.edu.ph / bpsu@bpsu.edu.ph / bpsu@bpsu.edu.ph
TELEPHONE NO. 1 (0477) 257-15-68

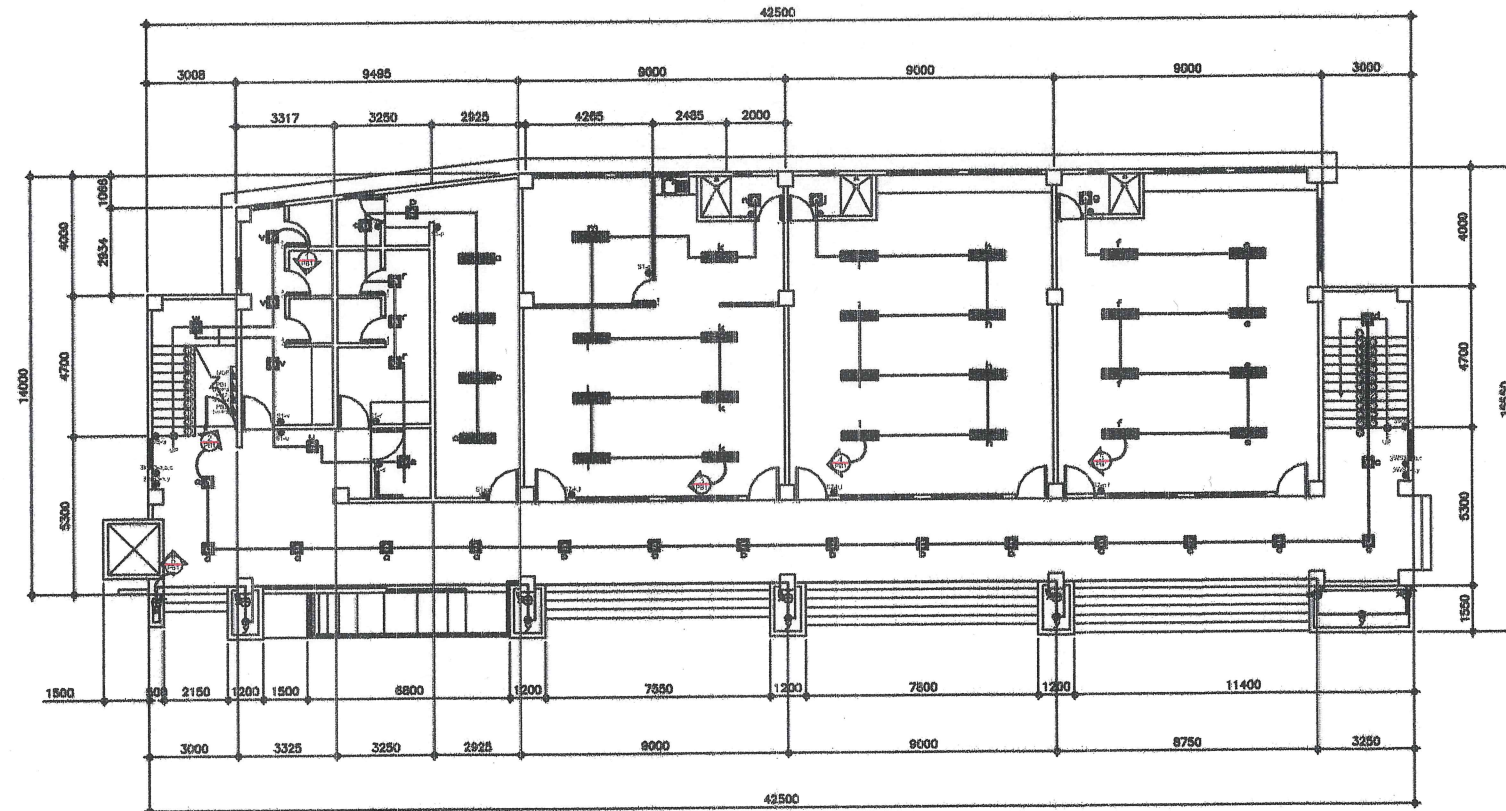

1 GROUND FLOOR
LIGHTING LAYOUT
E-1 SCALE 1:140MTS.

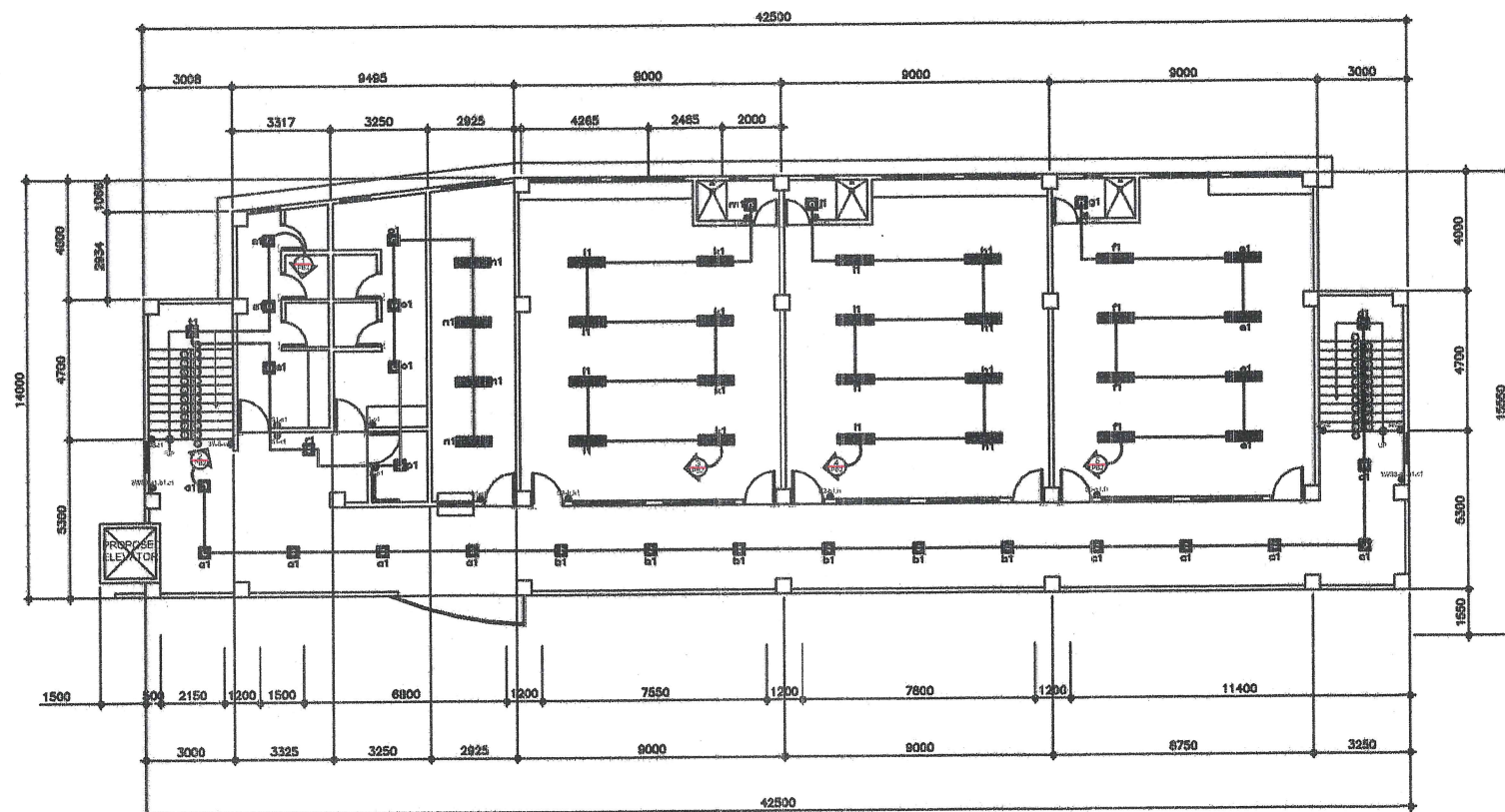

2 SECOND FLOOR
LIGHTING LAYOUT
E-1 SCALE 1:140MTS.

- ☐ FOR APPROVAL
☐ FOR CONSTRUCTION
☐ AS-BUILT PLAN

PROJECT TITLE:

CONVERSION OF THREE STOREY
BUILDING INTO INTERIM BUILDING
FOR COLLEGE OF MEDICINE
AT BPSU MAIN CAMPUS

LOCATION:
BATAAN PENINSULA STATE UNIVERSITY (MAIN CAMPUS)
BALANGA CITY, BATAAN

STRUCTURAL ENGINEER

REG. NO.:
P.E. NO.:
PLACE:
SIGNATURE:

MASTER PLUMBER/SANITARY ENGINEER

REG. NO.:
P.E. NO.:
PLACE:
SIGNATURE:

PROFESSIONAL ELECTRICAL ENGINEER

REG. NO.:
P.E. NO.:
PLACE:
SIGNATURE:

PROFESSIONAL MECHANICAL ENGINEER

REG. NO.:
P.E. NO.:
PLACE:
SIGNATURE:

END USER:

CAMPUS DIRECTOR

PREPARED BY:

AR. SHARON R. BAPTISTA
ARCHITECT

REVIEWED BY:

ENGR. ROY JOSEPH P. ENRIQUEZ
DIRECTOR OF PPES

RECEIVED BY:

PROF. JOERALD M. GADIA
VICE PRESIDENT ADMIN & FINANCE

APPROVED BY:

DR. RUBY B. SANTOS-MATIBAG
UNIVERSITY PRESIDENT

REPUBLIC ACT 9266.

NOTE: THIS DRAWING, AS AN INSTRUMENT
OF SERVICE IS THE PROPERTY OF:
BATAAN PENINSULA STATE UNIVERSITY
AND AS SUCH MUST NOT BE REPRODUCED
OR COPIED IN PART OR IN WHOLE
WITHOUT THEIR PERMISSION ALL
DRAWINGS ARE TO BE RETURNED WHEN
NO LONGER IN USE.

SHEET CONTENT:

-GROUND FLOOR
LIGHTING LAYOUT
-SECOND FLOOR
LIGHTING LAYOUT

E-1