

IF IN DOUBT, ASK
DO NOT SCALE!

ANY DISCREPANCY ON ALL DRAWINGS & SPECIFICATIONS
(ARCHITECTURAL, STRUCTURAL, SANITARY, ELECTRICAL,
MECHANICAL, ETC.) SHALL BE SUBJECT FOR VERIFICATION

DIMENSIONS, CONTRACTORS SHALL VERIFY AND BE RESPONSIBLE FOR ALL DIMENSIONS
AND CONDITIONS ON THE JOB. THE DESIGNER MUST BE NOTIFIED IMMEDIATELY OF ANY
VARIATIONS FROM THE DIMENSIONS AND CONDITIONS SHOWN BY THESE DRAWINGS.

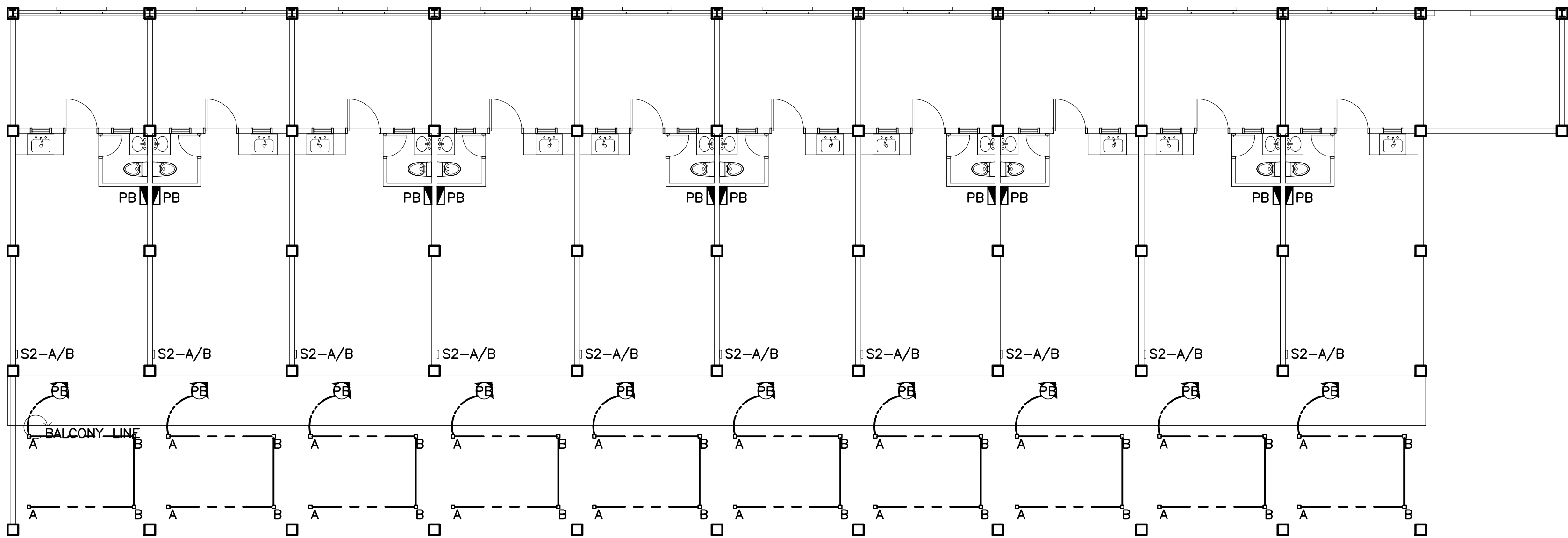

A LIGHTING LAYOUT
P-FDC-01 P-FDC-01 SCALE : 1:100 MTS.

ELECTRICAL LEGEND & SYMBOLS			
LEGEND	DESCRIPTION	LEGEND	DESCRIPTION
	6w, LED PANEL LIGHT		PANEL BOARD
	CONVENIENCE OULET		CIRCUIT LINE
	ACU OUTLET (INVERTER TYPE)		
	CIRCUIT HOMERUN		
S1°	ONE GANG SWITCH		
S2°	TWO GANG SWITCH		
S3°	THREE GANG SWITCH		

GENERAL NOTES

- ALL WORKS SHALL COMPLY WITH THE PROVISION OF THE LATEST EDITION OF THE PHILIPPINE ELECTRICAL CODE (PEC) AND SPECIFICATION WITH THE REQUIREMENTS AND ORDINANCE OF THE BUILDING OFFICIALS WITH JURISDICTIONS. BUREAU OF FIRE DEPARTMENT AND LOCAL POWER/ TELEPHONE COMPANY.
 - UTILIZATION VOLTAGE SHALL BE 230V 3 Ø 60 Hz.
 - WORKMANSHIP SHALL BE HIGHEST STANDARDS AND QUALITY. ALL MATERIALS TO BE USED FOR INSTALLATION SHALL BE NEW SUITABLE FOR THE TYPE AND PURPOSE OF APPLICATION.
 - EXPOSED WIRING WORK SHALL RUN IN PANEL OR PERPENDICULAR TO THE BUILDING STRUCTURES AND FINISHES.
 - GENERAL MOUNTING HEIGHT OF DEVICES AND EQUIPMENT ARE AS FOLLOWS:
WALL SWITCHES = 1300 MM ON CENTER
WALL RECEPTACLES = 300 MM ON CENTER
PANEL BOARDS = 1800 MM ON CENTER
- REFER TO ARCHITECT FOR OTHER CASES OF INSTALLATIONS.
- ALL WORK SHALL BE DONE UNDER DIRECT SUPERVISION OF A DULY LICENSED ELECTRICAL ENGINEER/ MASTER ELECTRICIAN.



BATAAN PENINSULA STATE UNIVERSITY
TECHNICAL WORKING GROUP FOR INFRASTRUCTURE

CAPITOL COMPOUND, BROY, TENEJERO, CITY OF BALANGA, BATAAN,
E-MAIL: bpsu.teginfra2016@gmail.com/ bpsuppes2017@gmail.com
TELEPHONE NO. : (047) 237-15-98

PROJECT TITLE		
PROPOSED FACADE IMPROVE- MENT OF BUSINESS CENTER & ICT BUILDING		
LOCATION:		
BATAAN PENINSULA STATE UNIVERSITY DINALUPIHAN CAMPUS, DINALUPIHAN, BATAAN		
STRUCTURAL ENGINEER		
REG. NO. :		
PTR. NO. :		
PLACE :		
TIN NO. :		
MASTER PLUMBER/SANITARY ENGINEER		
REG. NO. :		
PTR. NO. :		
PLACE :		
TIN NO. :		
PROFESSIONAL ELECTRICAL ENGINEER		
REG. NO. :		
PTR. NO. :		
PLACE :		
TIN NO. :		
PROFESSIONAL MECHANICAL ENGINEER		
REG. NO. :		
PTR. NO. :		
PLACE :		
TIN NO. :		
REVISION		
NO.	DESCRIPTION	DATE
1		
2		
PREPARED BY:		
ENGR. MAR O. TAPIA		
TWO INSPECTORATE TEAM		
REG. NO. :		
PTR. NO. :		
PLACE :		
TIN NO. :		
REVIEWED BY:		
MR. BILLY ALIPIO		
CAMPUS DIRECTOR		
NOTED BY:		
ENGR. ALFREDO D. VALENTOS		
DIRECTOR OF PPES		
RECOMMENDED BY:		
DR. EDMUNDO C. TUNGOL		
VICE PRESIDENT ADMIN. & FINANCE		
APPROVED BY:		
DR. GREGORIO J. RODIS		
UNIVERSITY PRESIDENT		
REPUBLIC ACT 9266.		
NOTE: THIS DRAWING, AS AN INSTRUMENT OF SERVICE IS THE PROPERTY OF : BATAAN PENINSULA STATE UNIVERSITY AND AS SUCH MUST NOT BE REPRODUCED OR COPIED IN PART OR IN WHOLE WITHOUT THEIR PERMISSION ALL DRAWINGS ARE TO BE RETURNED WHEN NO LONGER IN USE,		
SHEET CONTENT:		SHEET NUMBER:
LIGHTING LAYOUT		E-FDC-01