

LEGENDS & SYMBOLS:

	SEWER LINE		FLOOR DRAIN (FD)		CATCH BASIN
	VENT		FLOOR CLEANOUT		GATE VALVE (GV)
	COLD WATER LINE		GROUND CLEAN OUT W/ ENCASEMENT		CHECK VALVE (CV)
	STORM LINE				VENT STACK THRU ROOF
					VENT CAP STAINLESS
					FLOOR DRAIN W/ WATERLESS TRAP

P

P-1

GROUND FLOOR WATER LINE

SCALE : 1:100 MTS



BATAAN PENINSULA STATE UNIVERSITY
TECHNICAL WORKING GROUP FOR INFRASTRUCTURE

CAPITOL COMPOUND, BRGY. TENEJERO, CITY OF BALANGA, BATAAN,
E-MAIL: bpsu.twginfo2016@gmail.com/ bpsupes2017@gmail.com
TELEPHONE NO. : (047) 237-15-98

FLOOR FINISH SCHEDULE		WALL FINISH SCHEDULE	PARTITION SCHEDULE
F-1	POLISHED CONCRETE EXPOSED AGGREGATES RESIN 3000 WITH SEALER		
F-2	POLISHED CONCRETE SALT AND PEPPER RESIN 3000 WITH SEALER		
F-3	3000 X 3000 & 3000 X 6000 CERAMIC TILES NON-SKID		
F-4	SMOOTH FINISH CEMENT WITH WATER-PROOFING		

PROJECT TITLE:

CONSTRUCTION OF TWO-STOREY DORMITORY FOR STUDENTS AT ORANI CAMPUS

LOCATION:
BATAAN PENINSULA STATE UNIVERSITY, ORANI CAMPUS

STRUCTURAL ENGINEER
REG. NO. :
PTR. NO. :
PLACE :
TIN NO. :

MASTER PLUMBER/SANITARY ENGINEER
REG. NO. :
PTR. NO. :
PLACE :
TIN NO. :

PROFESSIONAL ELECTRICAL ENGINEER
REG. NO. :
PTR. NO. :
PLACE :
TIN NO. :

PROFESSIONAL MECHANICAL ENGINEER
REG. NO. :
PTR. NO. :
PLACE :
TIN NO. :

REVISION

NO.	DESCRIPTION	DATE
2		

PREPARED BY:

AR. ROXETTE S. UMEREZ
ARCHITECT 1, BPSU TWG
REG. NO. :
PTR. NO. :
PLACE :
CHECKED BY:

AR. JO-ANA Z. TANEGA
ARCHITECT 1, PPES OFFICE
REG. NO. :
PTR. NO. :
PLACE :
REVIEWED BY:

AR. DANILO Y. GALURA
ARCHITECT II, TWG CONSULTANT

RECOMMENDED BY:

DR. EDMUNDO C. TUNGOL
VICE PRESIDENT ADMIN. & FINANCE

APPROVED BY:

DR. GREGORIO J. RODIS
UNIVERSITY PRESIDENT

REPUBLIC ACT 9266.
NOTE: THIS DRAWING, AS AN INSTRUMENT OF SERVICE IS THE PROPERTY OF : BATAAN PENINSULA STATE UNIVERSITY AND AS SUCH MUST NOT BE REPRODUCED OR COPIED IN PART OR IN WHOLE WITHOUT THEIR PERMISSION ALL DRAWINGS ARE TO BE RETURNED WHEN NO LONGER IN USE.

SHEET CONTENT: GROUND FLOOR WATER LINE
LEGENDS & SYMBOLS

SHEET NUMBER: P1

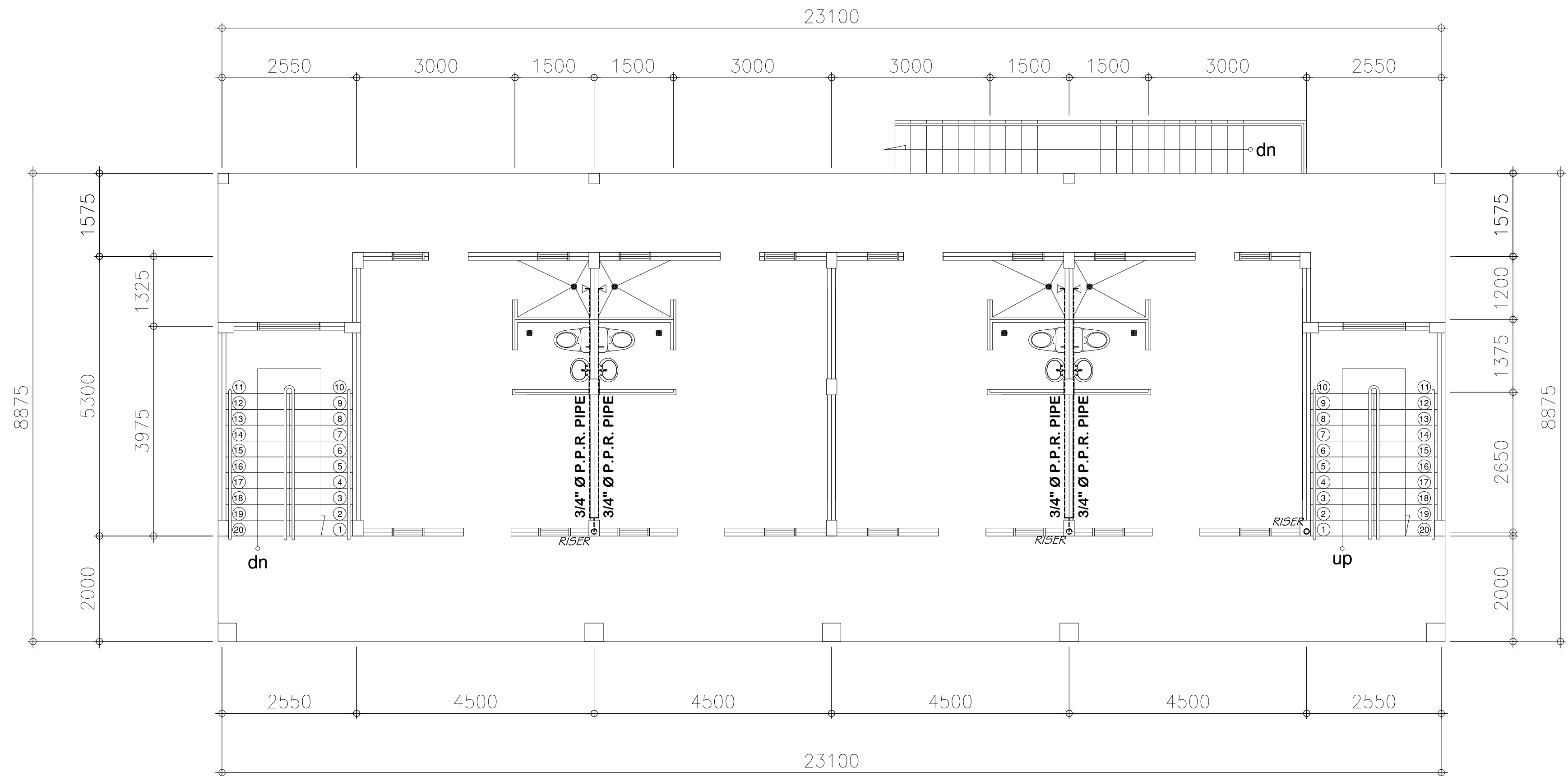

P SECOND FLOOR WATER LINE
P-2 P-2 SCALE : 1:100 MTS

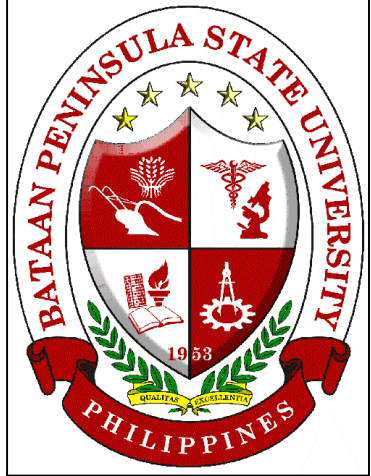

BATAAN PENINSULA STATE UNIVERSITY
TECHNICAL WORKING GROUP FOR INFRASTRUCTURE
CAPITOL COMPOUND, BRGY. TENEJERO, CITY OF BALANGA, BATAAN,
E-MAIL: bpsu.twginfo2016@gmail.com/ bpsupes2017@gmail.com
TELEPHONE NO. : (047) 237-15-98

FLOOR FINISH SCHEDULE		WALL FINISH SCHEDULE	PARTITION SCHEDULE
F-1	POLISHED CONCRETE EXPOSED AGGREGATES RESIN 3000 WITH SEALER		
F-2	POLISHED CONCRETE SALT AND PEPPER RESIN 3000 WITH SEALER		
F-3	3000 X 3000 & 3000 X 6000 CERAMIC TILES NON-SKID		
F-4	SMOOTH FINISH CEMENT WITH WATER-PROOFING		

PROJECT TITLE:		
CONSTRUCTION OF TWO-STOREY DORMITORY FOR STUDENTS AT ORANI CAMPUS		
LOCATION:		
BATAAN PENINSULA STATE UNIVERSITY, ORANI CAMPUS		
STRUCTURAL ENGINEER		
REG. NO. :		
PIR. NO. :		
PLACE :		
TIN NO. :		
MASTER PLUMBER/SANITARY ENGINEER		
REG. NO. :		
PIR. NO. :		
PLACE :		
TIN NO. :		
PROFESSIONAL ELECTRICAL ENGINEER		
REG. NO. :		
PIR. NO. :		
PLACE :		
TIN NO. :		
PROFESSIONAL MECHANICAL ENGINEER		
REG. NO. :		
PIR. NO. :		
PLACE :		
TIN NO. :		
REVISION		
NO.	DESCRIPTION	DATE
2		
PREPARED BY:		
AR. ROXETTE S. UMEREZ		
ARCHITECT 1, BPSU TWG		
REG. NO. :		
PIR. NO. :		
PLACE :		
CHECKED BY:		
AR. JO-ANA Z. TANEGA		
ARCHITECT 1, PPES OFFICE		
REG. NO. :		
PIR. NO. :		
PLACE :		
REVIEWED BY:		
AR. DANILO Y. GALURA		
ARCHITECT II, TWG CONSULTANT		
RECOMMENDED BY:		
DR. EDMUNDO C. TUNGOL		
VICE PRESIDENT ADMIN. & FINANCE		
APPROVED BY:		
DR. GREGORIO J. RODIS		
UNIVERSITY PRESIDENT		
REPUBLIC ACT 9266.		
NOTE: THIS DRAWING, AS AN INSTRUMENT OF SERVICE IS THE PROPERTY OF : BATAAN PENINSULA STATE UNIVERSITY AND AS SUCH MUST NOT BE REPRODUCED OR COPIED IN PART OR IN WHOLE WITHOUT THEIR PERMISSION ALL DRAWINGS ARE TO BE RETURNED WHEN NO LONGER IN USE.		
SHEET CONTENT:		SHEET NUMBER:
SECOND FLOOR WATER LINE		P2

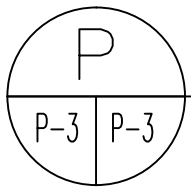
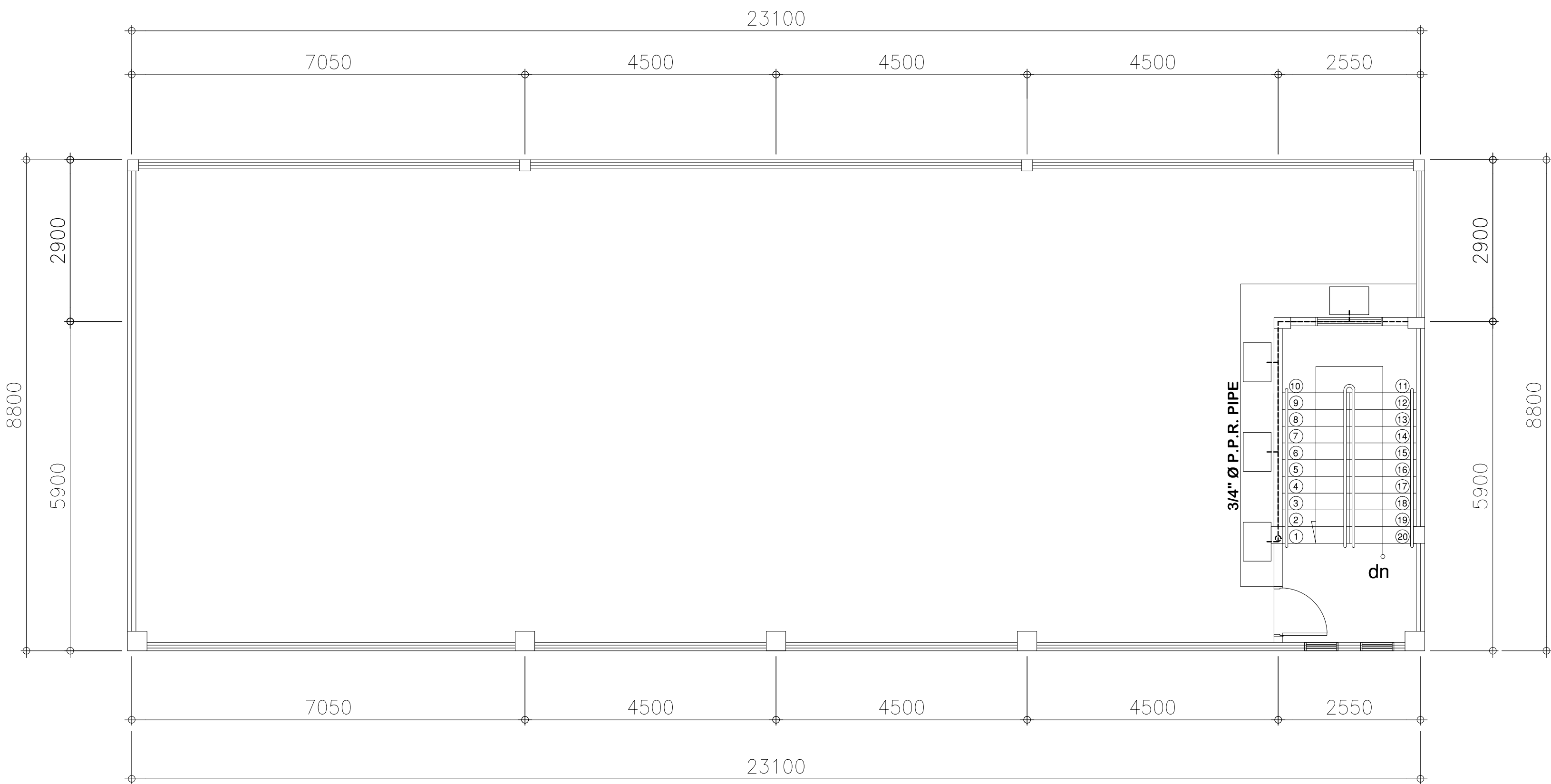

ROOF DECK WATER LINE
SCALE : 1:100 MTS

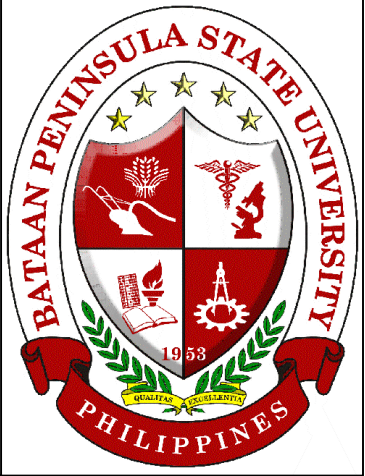

BATAAN PENINSULA STATE UNIVERSITY
TECHNICAL WORKING GROUP FOR INFRASTRUCTURE
CAPITOL COMPOUND, BRGY. TENEJERO, CITY OF BALANGA, BATAAN,
E-MAIL: bpsu.twginfo2016@gmail.com/ bpsupes2017@gmail.com
TELEPHONE NO. : (047) 237-15-98

FLOOR FINISH SCHEDULE		WALL FINISH SCHEDULE	PARTITION SCHEDULE
F-1	POLISHED CONCRETE EXPOSED AGGREGATES RESIN 3000 WITH SEALER		
F-2	POLISHED CONCRETE SALT AND PEPPER RESIN 3000 WITH SEALER		
F-3	3000 X 3000 & 3000 X 6000 CERAMIC TILES NON-SKID		
F-4	SMOOTH FINISH CEMENT WITH WATER-PROOFING		

PROJECT TITLE:

CONSTRUCTION OF TWO-STOREY DORMITORY FOR STUDENTS AT ORANI CAMPUS

LOCATION:
BATAAN PENINSULA STATE UNIVERSITY,
ORANI CAMPUS

STRUCTURAL ENGINEER
REG. NO :
PTR. NO :
PLACE :
TIN NO :

MASTER PLUMBER/SANITARY ENGINEER
REG. NO :
PTR. NO :
PLACE :
TIN NO :

PROFESSIONAL ELECTRICAL ENGINEER
REG. NO :
PTR. NO :
PLACE :
TIN NO :

PROFESSIONAL MECHANICAL ENGINEER
REG. NO :
PTR. NO :
PLACE :
TIN NO :

REVISION
NO. DESCRIPTION DATE
2

PREPARED BY:

AR. ROXETTE S. UMEREZ
ARCHITECT 1, BPSU TWG
REG. NO :
PTR. NO :
PLACE :

CHECKED BY:

AR. JO-ANA Z. TANEGA
ARCHITECT 1, PPES OFFICE
REG. NO :
PTR. NO :
PLACE :

REVIEWED BY:

AR. DANILO Y. GALURA
ARCHITECT II, TWG CONSULTANT

RECOMMENDED BY:

DR. EDMUNDO C. TUNGOL
VICE PRESIDENT ADMIN. & FINANCE

APPROVED BY:

DR. GREGORIO J. RODIS
UNIVERSITY PRESIDENT

REPUBLIC ACT 9266.
NOTE: THIS DRAWING, AS AN INSTRUMENT OF SERVICE
IS THE PROPERTY OF : BATAAN PENINSULA STATE
UNIVERSITY AND AS SUCH MUST NOT BE
REPRODUCED OR COPIED IN PART OR IN WHOLE
WITHOUT THEIR PERMISSION ALL DRAWINGS ARE
TO BE RETURNED WHEN NO LONGER IN USE.

SHEET CONTENT: SHEET NUMBER:
ROOF DECK WATER LINE
P3

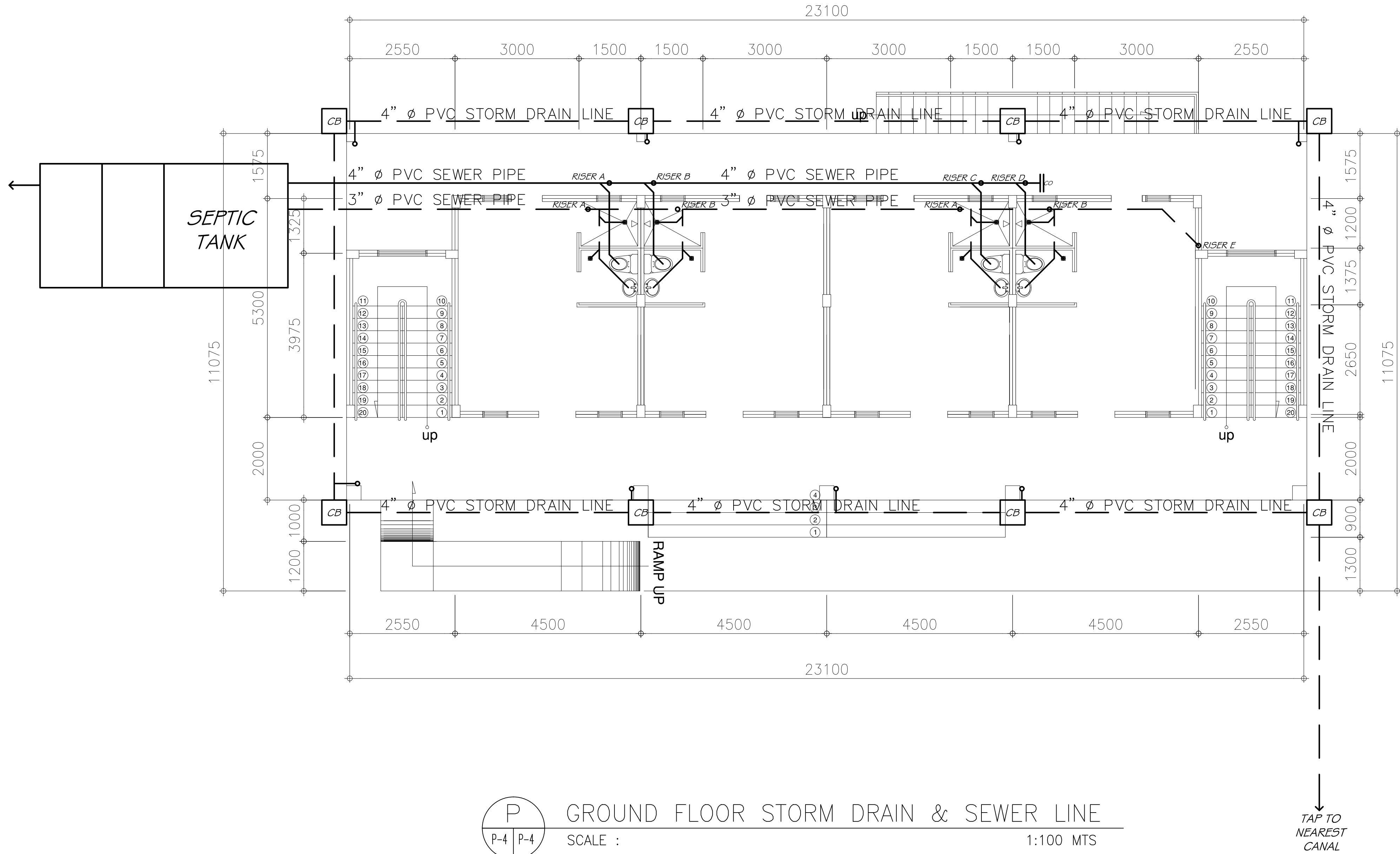

P GROUND FLOOR STORM DRAIN & SEWER LINE
P-4 P-4
SCALE : 1:100 MTS



BATAAN PENINSULA STATE UNIVERSITY
TECHNICAL WORKING GROUP FOR INFRASTRUCTURE
CAPITOL COMPOUND, BRGY. TENEJERO, CITY OF BALANGA, BATAAN,
E-MAIL: bpsu.twginfo2016@gmail.com/ bpsupes2017@gmail.com
TELEPHONE NO. : (047) 237-15-98

FLOOR FINISH SCHEDULE		WALL FINISH SCHEDULE	PARTITION SCHEDULE
F-1	POLISHED CONCRETE EXPOSED AGGREGATES RESIN 3000 WITH SEALER		
F-2	POLISHED CONCRETE SALT AND PEPPER RESIN 3000 WITH SEALER		
F-3	3000 X 3000 & 3000 X 6000 CERAMIC TILES NON-SKID		
F-4	SMOOTH FINISH CEMENT WITH WATER-PROOFING		

PROJECT TITLE:

CONSTRUCTION OF TWO-STOREY DORMITORY FOR STUDENTS AT ORANI CAMPUS

LOCATION:
BATAAN PENINSULA STATE UNIVERSITY, ORANI CAMPUS

STRUCTURAL ENGINEER
REG. NO :
PTR. NO :
PLACE :
TIN NO :

MASTER PLUMBER/SANITARY ENGINEER
REG. NO :
PTR. NO :
PLACE :
TIN NO :

PROFESSIONAL ELECTRICAL ENGINEER
REG. NO :
PTR. NO :
PLACE :
TIN NO :

PROFESSIONAL MECHANICAL ENGINEER
REG. NO :
PTR. NO :
PLACE :
TIN NO :

REVISION
NO. DESCRIPTION DATE
2

PREPARED BY:
AR. ROXETTE S. UMEREZ
ARCHITECT 1, BPSU TWG
REG. NO :
PTR. NO :
PLACE :
CHECKED BY:
AR. JO-ANA Z. TANEGA
ARCHITECT 1, PPES OFFICE
REG. NO :
PTR. NO :
PLACE :
REVIEWED BY:
AR. DANILO Y. GALURA
ARCHITECT II, TWG CONSULTANT
RECOMMENDED BY:
DR. EDMUNDO C. TUNGOL
VICE PRESIDENT ADMIN. & FINANCE
APPROVED BY:
DR. GREGORIO J. RODIS
UNIVERSITY PRESIDENT

REPUBLIC ACT 9266.
NOTE: THIS DRAWING, AS AN INSTRUMENT OF SERVICE IS THE PROPERTY OF : BATAAN PENINSULA STATE UNIVERSITY AND AS SUCH MUST NOT BE REPRODUCED OR COPIED IN PART OR IN WHOLE WITHOUT THEIR PERMISSION ALL DRAWINGS ARE TO BE RETURNED WHEN NO LONGER IN USE.

SHEET CONTENT: GROUND FLOOR STORM DRAIN & SEWER LINE
SHEET NUMBER: P4