

BATAAN PENINSULA STATE UNIVERSITY
TECHNICAL WORKING GROUP FOR INFRASTRUCTURE
CAPITOL COMPOUND, BRGY. TENEJERO, CITY OF BALANGA, BATAAN,
E-MAIL: bpauiwrg2016@gmail.com / bpauiwrg2017@gmail.com
TELEPHONE NO. : (047) 237-15-98

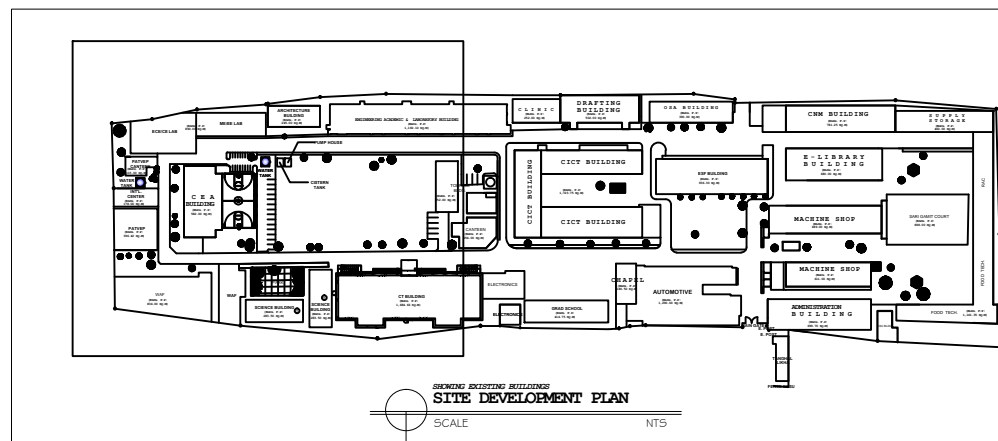

SCHEDULE SHEET		REPUBLIC OF THE PHILIPPINES DEPARTMENT OF PUBLIC WORKS & HIGHWAYS OFFICE OF THE BUILDING OFFICIAL		PROJECT TITLE REHABILITATION OF WATER SYSTEM AT MAIN CAMPUS		
ARCHITECTURAL		DISTRICT/CITY/MUNICIPALITY		LOCATION: BPSU MAIN CAMPUS, CITY OF BALANGA, BATANGAS		
SHEET NUMBER	DESCRIPTION					
		LAND USE & ZONING		STRUCTURAL ENGINEER		
				REG. NO. :		
				PRL. NO. :		
				PLACE :		
				TH. NO. :		
				MASTER PLUMBER/SANITARY ENGINEER		
				REG. NO. :		
				PRL. NO. :		
				PLACE :		
				TH. NO. :		
		LINE & GRADE		PROFESSIONAL ELECTRICAL ENGINEER		
				REG. NO. :		
				PRL. NO. :		
				PLACE :		
				TH. NO. :		
				PROFESSIONAL MECHANICAL ENGINEER		
				REG. NO. :		
				PRL. NO. :		
				PLACE :		
				TH. NO. :		
		ARCHITECTURAL		REVISION		
				NO.	DESCRIPTION	DATE
				1		
				2		
				PREPARED BY:		
				AR. ROXETTE S. UMEREZ		
				ARCHITECT 1, BPSU TWG		
				REG. NO. :		
				PRL. NO. :		
				PLACE :		
		SANITARY		CHECKED BY:		
				AR. JO-ANA MARI Z. TANEGA		
				ARCHITECT 1, PPES OFFICE		
				REG. NO. :		
				PRL. NO. :		
				PLACE :		
				REVIEWED BY:		
				AR. DANILO Y. GALURA		
				ARCHITECT II, TWG CONSULTANT		
				RECOMMENDED BY:		
		ELECTRICAL		DR. EDMUNDO C. TUNGOL		
				VICE PRESIDENT ADMIN. & FINANCE		
				APPROVED BY:		
				DR. GREGORIO J. RODIS		
				UNIVERSITY PRESIDENT		
				REPUBLIC ACT 9266.		
				NOTE: THIS DRAWING, AS AN INSTRUMENT OF SERVICE IS THE PROPERTY OF : BATANGA PENINSULA STATE UNIVERSITY AND AS SUCH MUST NOT BE REPRODUCED OR COPIED IN PART OR IN WHOLE WITHOUT THEIR PERMISSION ALL DRAWINGS ARE TO BE RETURNED WHEN NO LONGER IN USE.		
				SHEET CONTENT:		
				SITE DEVELOPMENT PLAN		
				MECHANICAL		
		ELECTRONICS				